

Renovation Fleece

UZIN RR 201

Fibreglass reinforcing fleece for self levelling compounds

MAIN APPLICATION FIELD:

- ▶ refurbishment of substrates in need of renovation
- ▶ reinforcement of self levelling compounds
- ▶ system component in UZIN Turbolight®-System

SUITABLE ON / FOR:

- ▶ all types of screeds, concrete
- ▶ existing substrates with well-bonded residues of adhesives or compounds
- ▶ P4 - P7 chipboard and OSB 2 - OSB 4 boards
- ▶ precast screeds, screed boards or raised-access floors
- ▶ UZIN footstep sound insulation or decoupling underlays
- ▶ changing substrates and transitions from breaks or screed supplements
- ▶ warm water underfloor heating systems
- ▶ suitable for residential, commercial and industrial areas
- ▶ system component in the composite system with UZIN RR 203



PRODUCT BENEFITS/FEATURES:

UZIN RR 201 is a fibre glass fleece with extremely high tensile strength and reinforcing effect when combined with UZIN primers and levelling compounds with A minimum thickness of 5 mm. The fibre glass fleece is penetrated by the levelling compound to improve the tensile strength reinforces in all directions. Movement and vibrations from the subfloor are absorbed and dissipated. In the composite system with UZIN RR 203, this effect is further enhanced. For interior use.

- ▶ extremely reinforcing
- ▶ covers cracks
- ▶ absorbs vibrations
- ▶ easy to apply
- ▶ low height from 5 mm



TECHNICAL DATA:

Packaging	rolls
Sizes	1.0 m x 60 m = 60 m ² 1.0 m x 30 m = 30 m ²
Shelf life	min. 24 months
Color	white
Area weight	approx. 120 g/m ²
Minimum application temperature	15 °C at ground level
Tensile strength at spinning thread	1.700 N/mm ²
Young modulus	72.000 N/mm ²

EXTENDED APPLICATIONS:

- ▶ renovation of substrates that have slight movement
- ▶ creation of a crack-free and load bearing substrate in the composite system with UZIN RR 203 and UZIN levelling compounds

SUBSTRATE PREPARATION:

The substrate must be dry and free from materials (dirt, oil, grease) that would impair adhesion. Test the substrate in accordance with applicable standard or notices and report any deficiencies. Any adhesion-reducing or unstable layers, e.g. release agents, loose adhesives, compounds, covering or paint residues, etc. must be removed, e.g. by brushing, abrading, grinding or shot-blasting. Thoroughly vacuum loose material and dust. Repair imperfections in the screed with a suitable mortar. Prime the cleaned substrate with a suitable primer. Cracks up to 3 mm width don't have to be closed. Use UZIN RR 203 crack bridge for cracks from 3 to 5 mm width, according to the product data sheet.

The datasheets for other used products have to be observed.

APPLICATION:

1. Apply an even coat of a suitable UZIN primer and allow to dry completely.
2. Roll out the renovation fleece and cut it to size with a scissor. Loosely install sheets over the surface and with 1 cm overlap onto the prepared substrate.
3. Smooth the UZIN levelling compound with a smoothing trowel or the WOLFF large surface rake with a minimum thickness of 5 mm. Spread the required thickness in one application.
4. Thoroughly aerate the levelling compound once applied using a suitable UZIN spike roller with crosswise movements.
5. Clean tools with water after use.

Composite system:

1. Apply UZIN RR 203 as described in the product data sheet.
2. Apply a coat of primer to the surface after the levelling compound has set.
3. Carry out further steps as described in Application, steps 2 – 5.

UZIN Turbolight®-System:

1. Installation as described in the application instructions for UZIN Turbolight®-System or according to the instructions by UZIN or codex Technical Departments.

APPLICATION EXAMPLES:



Existing substrate that needs refurbishment



Lay UZIN RR 201 over the entire surface to be renovated.

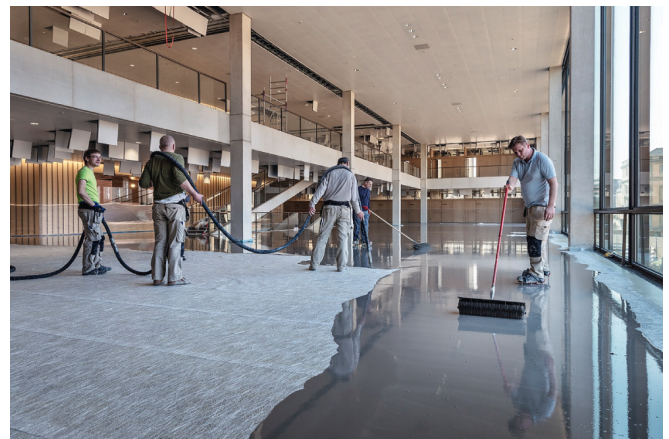

Pump UZIN NC 160 levelling compound over the UZIN RR 201.



UZIN RR 201 as a component in the UZIN Turbolight®-System.

wash face and hands after work. Refer to the notes on protection of the workplace and the environment in the Product Information Sheets for the other installation materials used.

DISPOSAL:

All product residues are treated as normal construction waste.

IMPORTANT NOTES:

- ▶ Shelf life minimum 12 months when stored in relatively cool conditions. Store rolls standing so as to avoid pressure marks. Frost-resistant up to - 25 °C.
- ▶ Best applied between 18 - 25 °C, substrate temperature above 15 °C and relative humidity below 65%.
- ▶ The assessment and renovation of existing substrates requires experience and solid technical knowledge. Obtain application advice if in doubt.
- ▶ Expansion, movement and perimeter joints in the substrate must be reflected through to the surface. Fit UZIN Foam Expansion Strips to any adjacent, vertical structures to prevent the ingress of the compound into the joints. For thicknesses over 5 mm foam expansion strips are necessary in general. On wooden substrates the foam expansion strip must be removed completely after installation.
- ▶ The substructure of wooden floors must be dry to prevent damage due to damp through rotting or mould formation. Adequate ventilation or rear-ventilation must be provided especially when installing impermeable flooring, e.g. by removing the existing expansion strip or by installing special skirting with vent openings.
- ▶ It is especially important for the primer and the compound to dry completely.
- ▶ UZIN RR 201 is also suitable for exterior areas when used with codex primers and levelling compounds that are also recommended for exterior application.
- ▶ Follow the generally acknowledged rules of the trade and technology for the installation of floor covering in respect of the applicable national standards (e.g. END, DIN, OE, SIA, etc.)

COMPOSITION:

Alkaline-resistant fibreglass, fixed with binding agent.

PROTECTION OF THE WORKPLACE AND THE ENVIRONMENT:

The product itself does not require any special labour protection measures. To protect against glass fibres contained in the product, it is recommended to wear protective clothing, suitable protective cream or protective gloves and to